

MED-A-GRAM

Spring 2015

NEBRASKA

**Society of
Medical Assistants**



AN AFFILIATE OF THE
AMERICAN ASSOCIATION OF MEDICAL ASSISTANTS



I AM A CERTIFIED MEDICAL ASSISTANT
"I aspire to render greater service"

★ **Grand Island**

★ **Great Plains**

★ **Hastings**

★ **Lincoln
State Conference**

★ **Omaha**

Important Registration Information

Enclosed the 2015 NSMA Conference Information Page 2

See the list of Newly Certified Medical Assistants Page 12

**Delegates Reports from the AAMA National Conference
In St. Louis, Missouri Page 19**

A publication of the
Nebraska Society of Medical Assistants

AN AFFILIATE OF THE AMERICAN ASSOCIATION OF MEDICAL ASSISTANTS

Editor:

Carol Hipke-Muske, CMA (AAMA)
1414 N Kansas Ave.
Hastings, NE 68901-3125
H) 402-463-7976
W) 402-460-2173
b_a_cma@hotmail.com

Official Publication of the Nebraska Society
of Medical Assistants. In affiliation with the
American Association of Medical Assistants.

All statements or comments in the Med-A-Gram
are the opinions or statement of the writer and are
not necessarily the opinion of the Nebraska
Society of Medical Assistants or American
Association of Medical Assistants.

Information contained within is meant to be
informative, enlightening and helpful, but is subject
to change.

American Association of Medical Assistants

www.aama-ntl.org

1-800-228-2262

Table of Contents

2015 NSMA Conference Information	2
2015 NSMA Conference Registration	5
Letter from the President	7
2014-2015 NSMA Elected and Appointed Board Members	8
Contacting the American Association of Medical Assistants (AAMA)	10
Newly Certified & Recertified Medical Assistants	12
CAAHEP & ABHES Accredited Colleges in Nebraska	13
Informing You for a Better You	14
2014 AAMA National Conference Report (condensed) & Photos	19

*If you would like a membership packet sent to a fellow Medical Assistant,
contact the NSMA Membership Chair:*

Janet Ueding, CMA (AAMA), LRT
909 L Street • Tekamah, NE 68061
402.808.4190
ueding48@yahoo.com

Conference Information

Nebraska Society of Medical Assistants

Attention CMAs (AAMA), RNs, LPNs and Medical Office Personnel

As the Nebraska Society of Medical Assistants Conference Chairs, it is our privilege and pleasure to extend this official invitation to you to attend the 49th annual NSMA Conference. The conference will be held at the Country Inn & Suites Conference Center, 5353 N.27th St., Lincoln, Nebraska.

Included is the registration form and hotel reservation information. As you will notice on the registration form, you have the option of the full two-day registration, which is your best deal or individual days if you are not able to come for the entire conference. Registration will begin Friday at 7:30 AM. There will be approximately 10-12 hours of continuing education presented. The applicable fees are included in the registration fee. Registration deadline is April 1, 2015, **no refunds** after April 10, 2015.

On the hotel reservation information sheet, note the deadline for room reservations. **Monday, March 23, 2015** is the last date to obtain the special conference group rate. Do not wait to make your hotel reservations as the allotment of rooms may fill up before the deadline date.

A special invitation is extended to all first-time conference attendees, non-members, and medical assisting students. You will be able to meet other medical assistants, share ideas with them and look at the organization and all it has to offer. There will be members available to answer any questions regarding our organization.

We will be honoring members and installing our newly elected board members during the conference. Meals that are included in the registration fee include the Friday Luncheon and Saturday Luncheon. The winners of the NSMA raffle drawing will be announced on Saturday.

Make a note for your packing. It is difficult to keep the temperature in all rooms comfortable for everyone, so please dress in layers---if desired. Please dress professional- casual business attire is required for the entire conference including the CEU sessions and business meetings. No blue jeans, sweats, scrubs or cutoffs.

The Country Inn & Suites is conveniently located just off I-80 on N.27th Street. This hotel provides easy access to numerous attractions, including downtown Lincoln, the Nebraska State Capitol and Lincoln Children's Zoo. It is also convenient to Lincoln Municipal Airport, Memorial Stadium, Antelope Park and several area businesses and restaurants.

Guests of this Lincoln, NE hotel will enjoy many amenities such as... complimentary high-speed Internet, heated indoor pool, fitness center, pet friendly, and on-site dining. The hotel also provides free continental breakfast featuring beverages, muffins, cereals, breads, fruit, and waffles!

As we gather together to attend the 49th Annual NSMA Conference, we hope your stay is enjoyable and comfortable. May we take this opportunity to continue growing in our profession and to become the best Medical Assistants we can be!

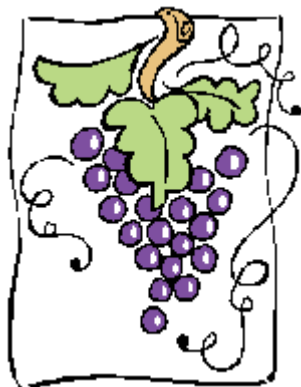

The Lincoln Chapter welcomes you to Lincoln for a special event!

Friday evening, April 17, 2015, from 6-9pm, the Lincoln Chapter has planned a social event for Medical Assistants in town for the NSMA Annual Conference. We have reserved a party room at James Arthur Vineyards located just 15 minutes northwest of Lincoln in Raymond, Nebraska. We will be having wine sampling from the local Nebraska winery along with an appetizer buffet.

The cost is \$25 per person for the entire evening. **Space is limited to the first 50 registrations received for this event.** Final deadline for available spaces is April 1st!

Send this separate registration form and check, payable to the Lincoln Chapter of Medical Assistants to the information below. If you have any questions before mailing, please contact Jen Kocian, the conference treasurer.

Thank you and we hope to see you there!

-----Cut here and mail this lower portion with check-----

Registration for James Arthur Vineyards

Name _____

Address _____

City _____ State _____ ZIP _____

For possible questions only

Home Phone _____ Alternate Phone _____

email address _____

Mail registration and check to:

Jen Kocian, CMA (AAMA)
1601 Torreys Dr. Lincoln, NE. 68521
402-476-6833

Must be 21 to attend
Registrations will be returned if spaces have been filled.

Conference Agenda

People, Purpose, & Passion; The Pathway to Success
49th Annual NSMA Conference at the Country Inn & Suites
5353 N. 27th St., Lincoln, NE 68521, 402-476-5353
 (Sessions and times subject to change)

Name badges must be worn at all times for admittance to all CEU sessions and meals

Friday, April 17, 2015

7:30am - 9:30am	Registration (Foyer of the Convention Center)	
8:00am – 9:00am	Pre-Conference Board Meeting (Nebraska Room)	
9:30am – 10:00am	Welcome to Lincoln by Mayor Chris Beutler (All sessions will be in the Nebraska Room)	
10:00am – 11:00am	HIPAA Judy Ehley	1 CEU
11:00am - 11:15am	BREAK	
11:15am- 12:15pm	Immunizations Dr. Sahra Niazi, Complete Children's Health	1 CEU
12:15pm- 1:00pm	Luncheon/ Exhibits	
1:00pm- 3:00pm	Diabetes, Thyroid, Weight Loss resistance Dr. Gregg Mongeon, Cornerstone Chiropractic	2 CEUs
3:00pm- 3:15pm	BREAK	
3:15pm-4:15pm	Working with Youth: Psychology, Nutrition, Obesity, and Services for Low Income Families William Michener, Director of Lighthouse	1 CEU
4:15pm- 4:30pm	BREAK	
4:30pm- 5:30pm	CEU (TBA) AAMA representative	1 CEU

Saturday, April 18, 2015

7:30am - 9:30am	Registration (Foyer of the Convention Center)	
8:00am – 9:30am	House of Delegates	
10:00am – 12:00pm	ICD-10, Medicare, Medicaid Terry Bramhall, CPC	2 CEUs
12:15pm – 1:30pm	Awards/ Installation of NSMA Officers/ Luncheon	
1:30pm – 2:00pm	Exhibits	
2:00pm – 3:00pm	Hepatitis C Rebecca Jurgens, APRN, Gastroenterology Specialties, PC	1 CEU
3:00pm – 3:15pm	BREAK	
3:15pm – 4:15pm	CEU (TBA)	1 CEU
4:30pm – 5:30pm	CEU (TBA)	1 CEU
5:30pm – 6:30pm	Post Conference Board meeting (Capital Room)	

Because we are honoring our elected officers and special guests this weekend, we ask that you dress in casual business attire, no blue jeans, scrubs, sweats or shorts, 'Thank you' for your professionalism and consideration."

Registration Form**Nebraska Society of Medical Assistants 49th Annual Conference Registration
April 17 & 18, 2015**

Name:		Credentials:	
Address:			
City:		State & ZIP:	
Email:		Phone:	
Chapter:		AAMA ID or SS#:	
1. <input type="checkbox"/> Yes <input type="checkbox"/> No Is this your 1 st NSMA Conference? 2. <input type="checkbox"/> Yes <input type="checkbox"/> No Are you a past State President? 3. <input type="checkbox"/> Yes <input type="checkbox"/> No Are you a Newly Certified CMA (AAMA) within the past 12 months? 4. <input type="checkbox"/> Yes <input type="checkbox"/> No Have you Recertified your CMA (AAMA) credential since April of 2014? (mo/yr _____)			

FULL TWO-DAY REGISTRATION (11 CEUs and Two meals)

- ☐ Members (meals & educational sessions) \$120.00
- ☐ Non-Members (meals & educational sessions) \$210.00
- ☐ Students (meals & educational sessions) \$110.00
- ☐ Students (educational sessions only) \$ 35.00

FRIDAY ONLY (6 CEUs and One meal)

- ☐ Members (meal & educational sessions) \$ 80.00
- ☐ Non-Members (meal & educational sessions) \$120.00
- ☐ Students (meal & educational sessions) \$ 60.00
- ☐ Students (educational sessions only) \$ 20.00

SATURDAY ONLY (5 CEUs and One meal)

- ☐ Members (meal & educational sessions) \$ 80.00
- ☐ Non-Members (meal & educational sessions) \$120.00
- ☐ Students (meal & educational sessions) \$ 60.00
- ☐ Students (educational sessions only) \$ 20.00

OPTIONS

- ☐ GUEST Friday evening meal ticket _____ @ \$25.00
- ☐ GUEST Saturday luncheon/awards ticket _____ @ \$25.00
- ☐ LATE FEE for Registration _____ @ \$15.00

(Will be added to all registrations postmarked after April 1, 2015)

Registrations will be processed at the registration rate available when payment is received

TOTAL \$ _____

To provide accurate meal counts, please check the following:

- ☐ I plan on attending the Friday Luncheon meal
- ☐ I plan on attending the Saturday luncheon/awards meal

Alcoholic beverages, illicit drugs, and smoking are prohibited during the conference-sponsored events.

Conference name badges must be worn for admittance to all CEU sessions and meals

Watch the NSMA website for conference updates
www.nsmaonline.org**Registration Deadline is
April 1, 2015.**

No Refunds after April 10, 2015.

Make Check Payable To:
2015 NSMA CONFERENCE**Mail Check and Registration To:**
Jen Kocian, CMA (AAMA)
1601 Torreys Dr. Lincoln, NE.
68521
402-476-6833

The continuing education sessions at this conference have been approved by the AAMA for CEUs. Granting approval in no way constitutes endorsement by the AAMA of either the program's content or facilitator.

Photos taken throughout the conference may be utilized in NSMA media.

Friday and Saturday - Breakfast buffet with paid hotel registration from 6:00 am - 7:45 am

Hotel Reservation Information

2015 NSMA Conference

April 17 & 18, 2015, Lincoln, Nebraska 68521



5353 N. 27th St. Lincoln, NE 68521

(402) 476-5353

www.countryinns.com/lincolnne

NSMA Group Room rate **deadline is Monday March 23, 2015**

FREE Continental Breakfast Included

Specify NSMA Conference when making reservation.

Hotel Reservation Information

1 room 2 double beds - \$114.99

1 room King bed - \$114.99

*If registered by Thursday, March 26, 2015

Check In-3:00pm

Check Out-Noon

Directions: Interstate 80 to exit #403, then go South on 27th St., 1.5 miles to hotel.
Country Inn & Suites is located on the West side of 27th St.

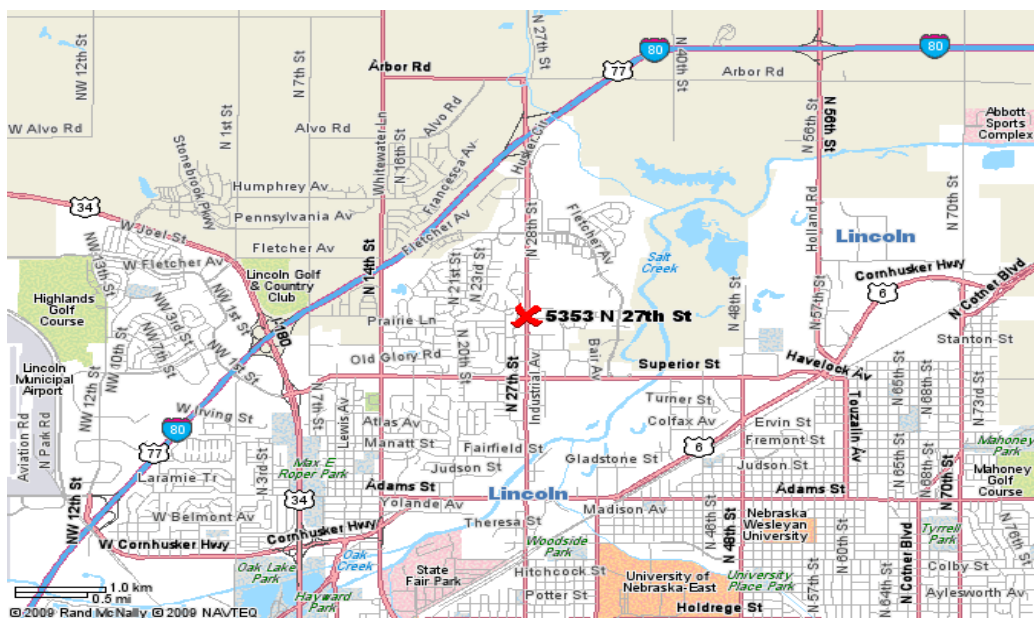

Letter From The President



For the past year, it has been my privilege to serve as your state president. As we prepare to flip our calendars to 2015, I am filled with hope for our future – not only as Certified Medical Assistants (AAMA), but also as an organization. As my second term as your NSMA President comes to a close, I want to thank my Board for a very rewarding and productive year.

This past year the Board of Directors conducted a strategic planning session to identify our organizations strengths, weaknesses, opportunities and threats. Strategic planning is used to help an organization do a better job of focusing its energy to ensure that members of the organization are working toward the same goals, and to assess and adjust the organization's direction in response to a changing environment. A variety of topics were identified and a strategic plan will need to be developed on how best to move forward with the information received from this planning session.

During the AAMA Conference in St. Louis, Missouri last October, Nebraska was the recipient of two Excel Awards, one for our Med-A-Gram publication and the other for our website NSMAonline.org. It was nice to be recognized for our efforts.

I look forward to seeing everyone at the Annual NSMA Conference in Lincoln. The Lincoln Chapter has been busy planning and preparing to host the 2015 NSMA Conference on April 17th & 18th at the Country Inn & Suites, 5353 N. 27th St. Lincoln, NE. During this conference, Vice-President Nicole Dvorak, CMA (AAMA) from the Omaha Chapter will be installed as President and I would like to wish her all the best. As conference draws closer, be sure to periodically check the NSMA website for any updates.

I have been fortunate to have had a mixture of new and seasoned members on the Board this year. I want to commend the new members for stepping up to serve and thank the seasoned members for their expertise and guidance.

Finally, to my Board, thank you for your ongoing dedication to NSMA — you truly make a difference!

Debra K. Potratz, CMA (AAMA)
2014-2015 NSMA President

2014-2015 NSMA Officers

2014-2015 NSMA Board of Directors



The 2014-15 elected NSMA Officers: R-L~ President Debra Potratz, CMA (AAMA), Vice President Nicole Dvorak, CMA (AAMA), Immediate Past President Andy Stewart, CMA (AAMA), Treasurer Linda Allensworth, CMA (AAMA), CPC, Secretary Terrie King, CMA (AAMA), Speaker of the House Leigh Perez, CMA (AAMA), Vice Speaker of the House Ashley Helms, CMA (AAMA)

PRESIDENT

Debra Potratz, CMA (AAMA) h)308.382.6123
814 Sweetwood Dr
ba.cma.aama2@gmail.com
Grand Island, NE 68803

VICE PRESIDENT

Nicole Dvorak, CMA (AAMA) Methodist Physician Clinic
57 Wenwood Circle Pediatrics
Council Bluffs, IA 51503 w) 712.396.4310 ext 4288
712.325.0106 brysmom@hotmail.com
c) 402.214.3319

IMMEDIATE PAST PRESIDENT

Andrea Stewart, CMA (AAMA) Family First Health Center
PO Box 432 w) 308.386.4799
Sutherland, NE 69165 f) 308.386.4343
h) 308.386.6074
andycma@yahoo.com

SECRETARY

Terrie King, CMA (AAMA) h) 712.322.2674
3114 Ave I w) 712.396.4139
f) 712.396.4217

Council Bluffs, IA 51503-4913

terriek1@hotmail.com

SPEAKER OF THE HOUSE

Leigh Perez, CMA (AAMA) Rheumatology Consultants
921 N 168 Ave Omaha, NE 68118
Omaha, NE 68118-9309 w) 402.609.1200
402-289-3472
vieja799@aol.com

TREASURER

Linda Allensworth, CMA (AAMA), CPC Physicians Clinic, Inc
PO Box 283 Omaha, NE
Carson, IA 51525-0283 callensw@frontiernet.net
712.484.3446 c) 402.740.1164

VICE SPEAKER OF THE HOUSE

Ashley Helms, CMA (AAMA) 402.304.8039
5631 Salt Valley VW lincolnchaptersma@yahoo.com
Lincoln, NE 68512 402.421.3335

NSMA 2014-2015 Standing Committee Chairman

ARCHIVE

Jen Kocian, CMA (AAMA) 402.476.6833
1601 Torreys Drive
toddnjen320@neb.rr.com
Lincoln, NE 68521

AWARDS

Andrea Tiarks, CMA (AAMA) h) 712.325.1669
617 Arnold Ave w) 402.343.1122
andy4461@aol.com
Council Bluffs, IA 51503-5150

BUDGET & FINANCE

Nicole Dvorak, CMA (AAMA) Methodist Physician Clinic
57 Wenwood Circle Pediatrics
Council Bluffs, IA 51503 w) 712.396.4310 ext 4288
brysmom@hotmail.com c) 402.214.3319
712.325.0106

BYLAWS

Lori Kounovsky, CMA (AAMA) Alegent Creighton
PO Box 644 Clinic-Plainview
Plainview, NE 68769 PO Box 490
402.582.4506 Plainview, NE 68769
ldkounovskycma@yahoo.com 402.582.3434
f) 402.582.4667

CERTIFICATION / EDUCATION

Terrie King, CMA (AAMA) h) 712.322.2674
3114 Ave I terriek1@hotmail.com
Council Bluffs, IA 51503-4913 w) 712.396.4139
f) 712.396.4217

DOCUMENTS

Jan Frederick, CMA (AAMA) Heart Consultants
7217 N 74th St 1120 N 103rd Plaza, Ste 100
Omaha, NE 68122 Omaha, NE 68114
402.932.8561 w) 402.384.4192
janfrederickcma@cox.net f) 402.384.4202

EDITORIAL

Carol Hipke-Muske, CMA (AAMA) Central Community College-
1414 N Kansas Ave Hastings
Hastings, NE 68901 PO Box1024
402.463.7976 Hastings, NE 68902-1024
b_a_cma@hotmail.com 402.460.2173
Fax 402.460.2138
c) 402.984.5317
cmuske@cccneb.edu

MARKETING

Jennifer Svagera CMA (AAMA), NCPT, BS
520 S. 38th St Kaplan University
Lincoln, NE 68510 1821 K St
h) 402.540.8332 Lincoln, NE 68508
jenniferinnebraska@hotmail.com w) 402.437.2139
jsvagera@kaplan.edu

MEMBERSHIP

Janet Ueding, CMA (AAMA), LRT h) 402.808.4190
909 L Street ueding48@yahoo.com
Tekamah, NE 68061 c) 402.870.1327

MENTOR

Andrea Stewart, CMA (AAMA) Family First Health Center
PO Box 432 w) 308.386.4799
Sutherland, NE 69165 f) 308.386.4343
308.386.6074 andycma@yahoo.com

NSMA Website

Debra Potratz, CMA (AAMA) h)308.382.6123
814 Sweetwood Dr
ba.cma.aama2@gmail.com
Grand Island, NE 68803

PUBLIC AFFAIRS

Michel McKinney, CMA (AAMA) Central Community College-
4355 S Juniata Ave Hastings
Juniata, NE 68955 PO Box1024
402.756.6660 Hastings, NE 68902-1024
mmckinney@cccneb.edu w) 402.461.2405
f) 402.460.2138

2014 CONFERENCE CHAIR

Ashley Helms, CMA (AAMA) Lincoln Chapter

NSMA 2014-2015 Chapter Presidents

GRAND ISLAND	Jean Burmood, CMA (AAMA)	exflorgirl@aol.com
GREAT PLAINS	Andrea Stewart, CMA (AAMA),	andycma@yahoo.com
HASTINGS	Carol Hipke-Muske, CMA (AAMA)	b_a_cma@hotmail.com
LINCOLN	Ashley Helms, CMA (AAMA)	lincolnchaptersnsma@yahoo.com
OMAHA	Terrie King, CMA (AAMA)	terriek1@hotmail.com

If you would like more information on the NSMA or a membership packet sent to a fellow Medical Assistant, contact the NSMA Membership Chair-

Janet Ueding, CMA (AAMA), LRT
909 L Street • Tekamah, NE 68061 • 402.808.4190 • ueding48@yahoo.com

MEDICAL ASSISTING NEEDS YOU!

There are two easy ways to join:

Visit the website page: www.aama-ntl.org

Or call the AAMA's national office at 1-800-228-2262



AAMA Information

American Association of Medical Assistants

20 NORTH WACKER DRIVE, STE 1575 • CHICAGO, ILLINOIS, 60606-2903

TOLL FREE 1-800-228-2262 • FAX 1-312-899-1259

What is the Mission of the AAMA?

The mission of the American Association of Medical Assistants is to provide the medical assistant professional with education, certification, credential acknowledgment, networking opportunities, scope-of-practice protection, and advocacy for quality patient-centered health care.

Here is some exciting information that you can share with your members.

Have you seen the updated AAMA website? Many new changes have been made to the site, for example, once you have setup your login, you will be able to make updates to your personal information, renew your membership, and recertify online with the click of a mouse. To learn more about the updates, follow the information supplied by the AAMA below.

The website has new tutorials available to assist in navigating the site. The link can be found in the upper right hand corner of the home page.

AAMA Website - Time-Saving Tips

The AAMA website is new and improved! You no longer need to use your last name and ID number to sign in to the website. You will need to create a new account using your e-mail address.

Follow the link to begin your new AAMA website experience! <https://www.aama-ntl.org/register>

If you have any trouble, feel free to call us at 800/228-2262, ext. 774.

Extra Tip: For access to personal and professional information, such as your CEU transcript, sign in and click on "My Account" in the upper-right corner.

Recertify Online with AAMA CEUs - all of your CEUs appear on your AAMA CEU Transcript and it is within 30 days prior to your certification expiration date, apply online.

Recertify by Phone with AAMA CEUs - if all of your CEUs appear on your AAMA CEU Transcript, you do not need to fill out the application:

Call the AAMA Continuing Education Department at 800/228-2262. Have your credit card handy. (Recertification status will not be determined at the time of your call. As with mail-in applications, processing may take up to 30 days.)

The quickest way to join or renew your membership with AAMA is online.

While our two main fax numbers (312/899-1259 and 312/899-8391) still are in operation, we now also have some direct fax numbers to expedite some of the items you are sending.

Program Approvals – 312/635-3363

Attendance Forms – 312/635-3364

Rosters and labels can be requested from the website under the volunteer button drop-down menu.

Marketing materials can be ordered through the website store. Both can be accessed 24/7, when it's convenient for you.

How members are placed into chapters. Zip codes for chapters are provided to the national office by the state society president. Staff does not place members into chapters. The computer system automatically places members according to the zips provided by the state president. We suggest that state societies audit their zip codes periodically. If you would like to request a listing of the zip codes for your state, the state president can email us a request. Our team will make the changes you provide to us. If a member does not have a chapter near enough for a zip code assignment, they will be members-at-large within the state. Members can always call the national office and ask to be assigned to another chapter. The chapter reassignment will be locked in until another change is indicated by the member.

Look for the AAMA on Facebook also!

Student Buzz

"I want to be a *medical assistant* because..."

What made you want to become a medical assistant? Interest in the medical field? A desire to help others? Tell us!

Produce a short video or write an essay titled "I want to be a medical assistant because..." and send it in.

Your entry could win \$500!

(Sponsored by textbook publisher F.A. Davis.)

Your audience: Potential medical assisting students. Who better to tell them about entering the medical assisting profession than you!

Your pitch: Your story should inspire others to consider the profession and aspire to achieve the CMA (AAMA) credential.

Your judges: The AAMA Communications and Marketing Department

Your deadline: July 1, 2015

How to get started: Think about what you would say to a friend or an acquaintance to encourage them in pursuing medical assisting as a profession. Why did you choose it as your career path? Then, think about what you would tell this person about going after that CMA (AAMA) credential. What kind of professional edge does the credential provide?

Eligibility: You are eligible to enter if you enrolled in and have completed at least one quarter or semester at a postsecondary medical assisting program accredited by the Commission on Accreditation of Allied Health Education Programs (CAAHEP).

Submission requirements

Essay

- Send as an attachment via e-mail to communications@aama-ntl.org (Include the information from the form below in your e-mail message.)
- Length: 400–500 words
- Save in Microsoft Word .doc or .docx format

Video

- Must be submitted as a video file (.avi, .mpeg, .wmv, .mp4, .mov) on DVD (3 copies required)
- Length: 3-minute maximum
- No limit on number of actors in video

Judging criteria

- Essay entries will be judged based on writing quality, content, and overall effectiveness.
- Video entries will be judged on quality of production, content, and overall effectiveness.

Entries that do not meet all the submission requirements will automatically be disqualified. All entries become the property of the AAMA and will not be returned.

Essay entry: See submission requirements above.

Video entry: Fill out this form, detach it, and mail it by **July 1, 2015** with your entry to the AAMA.

Full name: _____

Academic institution address: _____

Address: _____

Academic institution city/state/ZIP: _____

City/state/ZIP: _____

Educator's name: _____

Daytime phone number: _____

E-mail address: _____

The academic institution name of your medical assisting program: _____



AMERICAN ASSOCIATION
OF MEDICAL ASSISTANTS
20 N. WACKER DR., STE. 1575
CHICAGO, ILLINOIS 60606

website: www.aama-ntl.org 800/228-2262



Newly Certified Medical Assistants

The Nebraska Society of Medical Assistants would like to acknowledge the following Certified Medical Assistants who passed their certification exam from March 1, 2014 to October 1, 2014

Newly Certified:

Adela Mustafic, CMA (AAMA)	Lincoln NE	Melissa A Tunesvik, CMA (AAMA)	Plattsmouth NE	Heather Renee Minniear, CMA (AAMA)	Omaha NE
Akossiwa Eli Abba-Moussa, CMA (AAMA),		Michaela D Wilcox, CMA (AAMA)	Beatrice NE	Janet M. Koranda, CMA (AAMA)	Fremont NE
QMA, CNA	Omaha NE	Mikayla M Rabe, CMA (AAMA)	Lincoln NE	Jeannine L. Elsbernd, CMA (AAMA)	Grand Island NE
Amanda M Cabrera, CMA (AAMA)	Omaha NE	Mitzi P Villalba, CMA (AAMA)	Schuyler NE	Jennifer Lynn Grefe, CMA (AAMA)	Arlington NE
Amy Elizabeth Kitzing, CMA (AAMA)	Beatrice NE	Nicole L Perry, CMA (AAMA)	Omaha NE	Jeri J. Herrera, CMA (AAMA)	Lincoln NE
April Marie Satchell, CMA (AAMA)	Lincoln NE	Pamela S Peterson, CMA (AAMA)	Lincoln NE	Jerri L. Neemann, CMA (AAMA)	Lincoln NE
Betsy R Brandt, CMA (AAMA)	Sprague NE	Raquel Torres, CMA (AAMA)	Omaha NE	Jill Serae Speece, CMA (AAMA)	Friend NE
Betty D Smith, CMA (AAMA)	Omaha NE	Renae Marie Terrano, CMA (AAMA)	Lincoln NE	Karen Sue Kahnk, CMA (AAMA)	Omaha NE
Brittany Elaine Allen, CMA (AAMA)	Cortland NE	Samantha Kaye Portsche-Burns, CMA		Kari Ellen Grams, CMA (AAMA)	Hastings NE
Brittany Morgan Howell, CMA (AAMA)		(AAMA)	Lincoln NE	Karla J. Blackstone, CMA (AAMA)	Superior NE
	Grand Island NE	Sara Elizabeth Jirovsky, CMA (AAMA)	Fremont NE	Katey Lynn Hodges, CMA (AAMA)	Nebraska City NE
Cassandra Lynn Milanuk, CMA (AAMA)	Lincoln NE	Shana R Fry, CMA (AAMA)	Norfolk NE	Kelly R. Dobesh, CMA (AAMA), CPC,	
Chelsea N Paul, CMA (AAMA)	Lincoln NE	Stephanie D Edwards, CMA (AAMA)	Lincoln NE	RCC, CIRCC	Grand Island NE
Christine Lien, CMA (AAMA)	Lincoln NE	Stephanie Sarah Ireland, CMA (AAMA)	Lincoln NE	Kerry Anne Davis, CMA (AAMA)	Hastings NE
Daphne Jean Dearing, CMA (AAMA)	Omaha NE	Terry L Williams, CMA (AAMA)	Lincoln NE	Kimberly J Hayes, CMA (AAMA)	Clarks NE
Deborah L Voges, CMA (AAMA)	Gretna NE	Tess Louise Peck, CMA (AAMA)	Wahoo NE	Kristina Kay Pilkenton, CMA (AAMA)	Fremont NE
Deborah S McVeigh, CMA (AAMA)	Lincoln NE	Theresa Whiting, CMA (AAMA)	Lincoln NE	Laci M Rexroad, CMA (AAMA)	Bellevue NE
Debra S. Peterson, CMA (AAMA)	Omaha NE	Tricia L Page, CMA (AAMA)	Wilber NE	Laura J. Blankenship, CMA-C (AAMA)	Arlington NE
Diana K Morgan, CMA (AAMA)	Omaha NE	Troy L Poole, CMA (AAMA)	Lincoln NE	Leslea K Calhoun, CMA (AAMA)	Clay Center NE
Dolores C Smith, CMA (AAMA)	Omaha NE	Vanessa Lynn Stanek, CMA (AAMA)	Prague NE	Lesley Brooke Miller, CMA (AAMA)	Cortland NE
Earl H Cohen, CMA (AAMA)	Omaha NE	Whitney Ann Gillespie, CMA (AAMA)	Omaha NE	Linnea R. Williams, CMA (AAMA)	Bellevue NE
Haleigh Marie Hanshaw, CMA (AAMA)	Beatrice NE	Yolanda Gonzalez, CMA (AAMA)	Omaha NE	Lisa Jean Spatz, CMA (AAMA)	Lincoln NE
Heather A Beal, CMA (AAMA)	Lincoln NE			Lisa L. Hatch, CMA (AAMA)	Juniata NE
Jami R Bowers, CMA (AAMA)	Lincoln NE	<u>Recertified CMAs (AAMA)</u>		Lori A Lesiak, CMA (AAMA)	Lincoln NE
Jessica Leah Bohaty, CMA (AAMA)	Lincoln NE	Alana J McCrillis, CMA (AAMA)	Blair NE	Luther O Wilson, CMA (AAMA)	Omaha NE
Joanne L Parker, CMA (AAMA)	Bellevue NE	Allison Vega, CMA (AAMA)	Lincoln NE	Mariann B. Fleischman, CMA (AAMA)	Elmwood NE
Jolene Kim Vander Veer, CMA (AAMA)	Hastings NE	Amber I. Basnett, CMA (AAMA)	Pleasanton NE	Natasha L. Pegans, CMA (AAMA)	Hickman NE
Jolynn Marie Courtier, CMA (AAMA)	Omaha NE	Andrea Nichole Engler, CMA (AAMA)	Lincoln NE	Rebecca A. Spaulding, CMA (AAMA)	Omaha NE
Joshua L Misner, CMA (AAMA)	Lincoln NE	Angela L. Feeney, CMA (AAMA)	Saint Paul NE	Rhonda Rae Sanford, CMA (AAMA)	Lincoln NE
Kara M Collins, CMA (AAMA)	Omaha NE	Angela Lee Romero, CMA (AAMA)	Omaha NE	Sarah J. Krueger, CMA (AAMA)	Springfield NE
Kari J Ferguson, CMA (AAMA)	Omaha NE	Ann T. Little, CMA (AAMA)	Omaha NE	Sharlyn E Davis, CMA (AAMA)	Omaha NE
Kerri A Chvatal, CMA (AAMA)	North Bend NE	Beth Ann Sheridan, CMA (AAMA)	Lincoln NE	Shelly A. Hankins, CMA (AAMA)	Lincoln NE
Kimberly Diane Todd, CMA (AAMA)	Fremont NE	Beverly J Dahlkoetter, CMA (AAMA)	Grand Island NE	Stacy Lynne Moormeier, CMA (AAMA),	
Kristie A Haffke, CMA (AAMA)	Omaha NE	Brenda D. Venhaus, CMA (AAMA)	Lincoln NE	LRT	Roca NE
Kristie Lynn Sebby, CMA (AAMA)	Lincoln NE	Catherine M Daugherty, CMA (AAMA)	Tekamah NE	Stephenie C. Kantos, CMA (AAMA)	Eagle NE
Laccie Lynn Marvin, CMA (AAMA)	Omaha NE	Christel Lynne Barth, CMA (AAMA)	Utica NE	Susan E Marx, CMA (AAMA)	Omaha NE
LaShell K Hunter, CMA (AAMA)	Talmage NE	Christine M. Eloge, CMA (AAMA)	Lincoln NE	Susan Kosmicki Foss, CMA (AAMA),	
LaTasha Lurline Wilwerding, CMA (AAMA)		Cindy A. Abbott, CMA (AAMA)	Omaha NE	LR	Grand Island NE
	La Vista NE	Crystal Dawn Longfellow, CMA (AAMA)	Auburn NE	Susan L Kizer, CMA (AAMA)	Overton NE
LaToya Genee Dixon, CMA (AAMA)	Bellevue NE	Cynthia A Dubas, CMA (AAMA)	York NE	Tami Lynn Newbrey, CMA (AAMA)	Scribner NE
Lindsay L Hard, CMA (AAMA)	Columbus NE	Debra L. Rall, CMA (AAMA)	Lincoln NE	Tanya Sue Colson, CMA (AAMA)	Lincoln NE
Makenna Rae Coy, CMA (AAMA)	Shickley NE	Diana L. Bensink, CMA (AAMA)	Plattsmouth NE	Teresa Marie Mikoloyck, CMA (AAMA)	Fremont NE
Mandy Jane Swetland, CMA (AAMA)	Lincoln NE	Dianne L. Rice, CMA (AAMA)	Lincoln NE	Tomi Lee McCuen, CMA (AAMA)	Yutan NE
Marcus Eusebio Tamez, CMA (AAMA)	Lincoln NE	Dona Marotta, CMA (AAMA), MHA,		Tracy Jo Bednar, CMA (AAMA)	Waterloo NE
Margarita Iarova, CMA (AAMA)	Lincoln NE	EMT-I	Omaha NE	Tracy Lynn Smith, CMA (AAMA)	Alexandria NE
Meghan Taylor Tucker, CMA (AAMA)	Bellevue NE	Emilia Veronica Moore, CMA (AAMA)	Bellevue NE	Tyanne Betar, CMA (AAMA)	Lincoln NE
		Erin E. Hoffmeyer, CMA (AAMA)	Lincoln NE	Valerie M. Ruckman, CMA (AAMA), AAS	Omaha NE

We try to get the most accurate list of newly Certified Medical Assistants from the AAMA, but we may inadvertently miss someone. Do know that we are proud of each and every one of you and your accomplishments. Congratulations on a job well done.

CAAHEP & ABHES Accredited Colleges in Nebraska

CENTRAL COMMUNITY COLLEGE**Medical Assisting Program**

CAAHEP Accredited: Associate

Michel McKinney, CMA (AAMA)

Program Coordinator

PO Box 1024

Hastings, NE 68902-1024

402-461-2405

F) 402-460-2138

mmckinney@cccneb.edu

KAPLAN UNIVERSITY - LINCOLN**Medical Assisting Program**

CAAHEP Accredited

Ryan Villwok, D.C.

Program Coordinator

1821 'K' St

Lincoln, NE 68508

402-474-5315

F) 402-474-5302

rvillwok@kaplan.edu

KAPLAN UNIVERSITY - OMAHA**Medical Assisting Program**

CAAHEP Accredited: Associate

Christine Carberry, RN, MA, MS, LMHP, CPC

Department Chair

5425 N 103rd St

Omaha, NE 68134

402.431.6130

F) 800.905.6041

christine.carberry@kaplan.edu

METHODIST COLLEGE**Medical Assisting Program**

CAAHEP Accredited

Marcia Franklin, RN, BSN

Program Coordinator

720 N 87th St

Omaha, NE 68114-2852

402-354-7076

F) 402-354-7250

marcia.franklin@methodistcollege.edu

METRO COMMUNITY COLLEGE**Medical Assisting Program**

CAAHEP Accredited

Dona Marotta, MHA, CMA (AAMA)

Program Director

P.O. Box 3777

Omaha, NE 68107

402-738-4713

f) 402-738-4554

dmmarotta@mccneb.edu

SOUTHEAST COMMUNITY COLLEGE**Medical Assisting Program**

CAAHEP Accredited: Diploma

Kathy Zabel, MA, BS, RRT, LRCP

Program Chair

8800 'O' St

Lincoln, NE 68520

f) 402-437-2592

kzabel@southeast.edu

NSMA Conference Updates**2015 NSMA's 49th Annual Conference, hosted by the Lincoln Chapter, April 17-18, 2015****2016 NSMA's 50th Annual Conference, hosted by the Grand Island Chapter, April 29-30, 2016****2017 NSMA's 51th Annual Conference, hosted by the Omaha Chapter, April 20-21, 2017**

Informing You For a Better You

When working outside we need to be smart about the way we dress and think so that we can stay safe this winter:

Two big concerns of working or simply spending time outdoors in cold weather are frostbite and hypothermia. Both can occur at much higher temperatures than many people realize. For example, exposed skin can start to freeze at just 28 degrees Fahrenheit (-2 degrees Celsius) and deep frostbite can cause blood clots and even gangrene. Hypothermia is a potentially fatal condition caused by loss of body temperature, even in winter conditions people might not consider particularly nasty. Symptoms include fatigue, nausea, confusion, lightheadedness and profuse sweating. Without medical treatment, the victim can lose consciousness and die.



- Choose the correct gloves for the work you are doing. Gloves should have enough insulation to keep you warm and prevent frostbite, but be thin enough so you can feel what you are doing if you are manipulating controls or tools. If they are too thick, they can also make your hands and wrists work too hard trying to hold on to objects, causing repetitive strain injury.
- Dress in layers of lightweight clothing, which keep you warmer than a single layer of heavy clothes. Remove layers as necessary to prevent overheating and perspiring, which can lead to chills or hypothermia later. Remember that wet clothing is 20 times less warm than dry clothing. Wear a hat and you will stay much warmer when working in cold conditions. As much as half your body heat can go up in steam off the top of a bare head. Protect your ears from frostbite as well by wearing a hat that will cover your ears, or use earmuffs.
- While wearing a scarf or muffler might help keep your neck warm in the cold weather, it could also kill you if you work near rotating machinery. Check your winter wardrobe for entanglement hazards such as loose sleeves and dangling drawstrings.
- Keep your safety eyewear from fogging up in the cold. Investigate anti-fog coatings and wipes to see if these products are appropriate for your eyewear. If you have to keep taking off your safety eyewear because it fogs up, it is not protecting you.
- Look at the soles of your winter footwear. Your shoes or boots should have adequate tread to prevent slips and falls on wet or icy surfaces. For extremely slippery situations, you can attach clogs or cleats to your footwear. Slow down when walking across slippery surfaces and be especially careful on ladders, platforms and stairways.
- Get plenty of rest. Working in the cold and even traveling to and from work in the winter takes lots of energy. Cold weather can strain your heart, even if you are not overexerting yourself, so be sure to pace yourself when lifting heavy objects or shoveling snow.

The average office worker spends 50 minutes a day looking for lost files and other items.



Germ Free

Phones are one of the most frequently used items in the office that we forget to clean, especially the ear and mouthpiece of the phone. Dip a soft bristled toothbrush in rubbing alcohol, shake off the excess and use the brush to clean the holes of the handset.

Prevent germapalooza from happening on your cutting board. Dampen a clean cloth with undiluted white vinegar and wipe the board down after each use.

Disinfect household sponges. Soak sponges in undiluted white vinegar overnight, and let air-dry before reuse.

Got Eggs?

Did you know eggs have 6 grams of protein of high quality protein? A protein packed breakfast helps us endure the mental and physical energy we need throughout the day.

Eggs are rich in choline. Choline promotes normal cell activity, liver function and the transportation of nutrients throughout the body.

Eggs have zero carbs and no sugar and they are not complicated with other ingredients that cereals and yogurt contain...they only contain eggs!

Eggs have no gluten.

Eggs are an easy and portable meal, when they have been hard-boiled first.

Eggs are an inexpensive source of high-quality protein at about 15 cents a serving.

**Raise the thermostats for the elderly**

While some say 1 degree can save you \$20 annually on your heating costs, and other say a cooler room can increase energy and improve insulin sensitivity, but for the elderly a lower thermostat can have a different outcome. Just 45 minutes of exposure to a chilly room can cause muscles to stiffen and impair movement in healthy women and possibly increase the risk of a fall. \$20 is not a benefit when it comes to recovering from a broken bone(s) for elderly family members.

22 Common Signs Your Loved Ones May Need Extra Help

Fluctuating weight

Balance problems

Unexplained burns or bruises

Excessive clutter (newspapers, piles of junk mail)

Unusual odors (urine, garbage)

Failure to turn off stove or water after use

Abusive behavior; outburst

Uncharacteristically anti-social behavior

Confusion

Repetition

Unfilled or untaken prescriptions

Sleeping too much or too little

Poor hygiene

Unkempt appearance

Unusual carpet stains

Not enough food in the house

Dents/scratches on the car

Mood swings

Lack of motivation

Memory loss

Hallucinations

Unpaid bills

SEEKING ACTIVE MEMBERS

As Mentor Committee Chair of the Nebraska Society of Medical Assistants (NSMA), I invite you to join me as an ACTIVE member of our Society. In the tradition of our distinguished Society, we want to continue to support the values and principles that have been established by our professional organization.

We are currently in full force of pursuing a larger ACTIVE membership base. We are widening our scope of efforts to seek new ideas and innovative approaches. With your interest and support, we hope to enhance opportunities for the membership and broaden our appeal to all Certified Medical Assistants (American Association of Medical Assistants).

No one is asking you to jump into a position that you are not comfortable with. There are many different levels of participation and many seasoned members willing to help walk you through the steps until you feel confident enough to chair a committee and get more involved.

To get you started, take a few minutes to read the NSMA Bylaws and Standing Rules that are printed in the Med-A-Gram. Next, talk to a member who has or is currently serving as an officer or committee chair from your Chapter or is a member on the NSMA Board of Directors. Ask to see one of the NSMA Policy Manuals. Review the NSMA Fact Sheets to see where your talents will fit in.

At this time, I have chosen the following position to inform you about the details of that position –

CERTIFICATION COMMITTEE FACT SHEET

TERM: One year

Appointed by the Vice President with NSMA BOD approval

QUALIFICATIONS:

Active member of NSMA in good standing

Must be a current CMA (AAMA)

Familiar with NSMA Bylaws and Standing Rules

Familiar with the CMAs (AAMA) Disciplinary Standards & Procedures

Understand basic parliamentary procedures

Thorough understanding of the AAMA certification and recertification policies and procedures

Strong organizational and communication skills

Ability to meet deadlines

Comprehensive understanding of the AAMA CEU approval process

RESPONSIBILITIES:

Attend all NSMA BOD meetings and the annual NSMA HOD

Keep the membership informed regarding the AAMA certification exam application process

Promote certification and recertification and the AAMA policy that all working CMA's (AAMA) remain current
Mail congratulatory letters to new and recertified members

Promote the proper use of the CMA (AAMA) credential in the workplace

Recognize new and recertified CMA's (AAMA) at the annual conference

Arrange and obtain AAMA CEU approval for educational sessions as requested

Develop and distribute program-advertising notices

Prepare a written yearend report

COMMITTEE MEMBERS:

Education Chair of each component chapter or appointee

NOTE: All committee members should be current CMA's (AAMA)

PROCEDURE NOTEBOOK CONTENTS:

Current NSMA operating budget and NSMA Financial Policies

Retain year end report for 5 years

Maintain a list of CEU program titles, CEU approval numbers and attendance lists for 5 years

Maintain roster of all Nebraska current CMAs (AAMA) - member and nonmember

Maintain demographic roster of allied health professional organizations

Current copy of AAMA's Program Planners Guide

CMA (AAMA) Logo Usage Policy

CMA (AAMA) Certification Examination Content Outline

Copy of AAMA Disciplinary Standards and Procedure for the CMA (AAMA)

Occupational Analysis of the Medical Assistant and Advanced Practice of Medical Assisting document

Current NSMA Bylaws and Standing Rules

Replace NSMA BOD roster yearly

Updated NSMA Planning Calendar

Update Certification/Education Committee calendar as needed

Revise/replace forms and samples as needed

CERTIFICATION/EDUCATION COMMITTEE:

The purpose of this committee is to promote AAMA certification and recertification throughout Nebraska. Certification is or should be the goal of all medical

assistants and achieving it is one of the most important steps in becoming a professional medical assistant. Achieving the CMA (AAMA) credential is evidence of competence in a demanding field. Per AAMA, a greater number of employers are preferring that their medical assistants be CMAs (AAMA) due to the reputation of the credential being the gold standard for the profession. Thus, CMAs (AAMA) comprise the majority of credentialed medical assistants in the workforce today.

The Certification Committee Chair and all committee members must be current CMAs (AAMA) and promote the AAMA policy that all working CMA's (AAMA) must remain current.

The Chair should maintain an effective level of political awareness regarding the medical assistant's right to practice and notify the NSMA Public Affairs Chair of any threats to the profession or noteworthy developments.

Chair is automatically a member of the NSMA Education Committee and shall be available to assist in coordination of educational programs.

Effective January 2008, the American Association of Medical Assistants certification title was changed and the proper official abbreviation is now CMA (AAMA). Chair shall market and promote the proper use of nametags in the workplace designating "CMA (AAMA)" as the correct professional title for those who qualify.

The CMA (AAMA) credential is awarded to medical assistant candidates who have successfully completed the AAMA certification/recertification exam administered by the Certifying Board of AAMA. The National Board of Medical Examiners® serves as test consultant for the CMA (AAMA) exam. As a result, the reliability and validity of the CMA (AAMA) credential is of the highest order. Only graduates of post-secondary medical assistant programs accredited by either CAAHEP or ABHES are eligible to take the CMA (AAMA) examination.

The certification exam is a comprehensive test of knowledge including administrative functions, clinical procedures and other general medical assistant activities in the medical office. Content breakdown includes anatomy and physiology, terminology, behavioral science, professionalism, communications, computer concepts, records management, practice finances, infection control, nutrition, collecting and processing specimens, medico legal issues, medication preparation and administration, examination room techniques, emergencies, etc. The examination is updated and reconstructed annually by the AAMA Certifying Board.

Chair should encourage and be available to assist Chapters and medical assisting schools in forming study groups to support candidates preparing for the exam. Candidates may be referred to the AAMA website, Candidate Application and Handbook document. Beginning January 2009, AAMA instituted continuous computer based testing (CBT) with immediate provisional

results for the certification examination. The AAMA website will provide step-by-step instructions on how to complete the exam application, confirm eligibility, list required documentation, current fees, testing locations and appointment information. It is recommend that all applicants review the CMA (AAMA)

Certification/Recertification Examination Content Outline and take the practice exams on line prior to official testing.

On verified successful completion of the exam, the AAMA Certifying Board (CB) will send a certificate, identification card and a CMA (AAMA) lapel pin to all new CMAs (AAMA). Recertifying CMAs (AAMA) will receive a certificate and wallet card.

To maintain the credential, CMA's (AAMA) are required to stay current in the medical assisting field by regularly updating skills and their knowledge base. Since 1988, a CMA (AAMA) must recertify every five years and failure to do so results in a "not current status." Effective January 2003, all certified medical assistants employed or seeking employment MUST have current status in order to use the CMA credential. The current or not current status of all CMA's (AAMA) is of public record and can be ascertained by contacting the AAMA Executive Office.

All newly certified and recertifying CMAs (AAMA) will be current through the last day of their birth month in the 6th (sixth) calendar year following certification or recertification.

A CMA (AAMA) may recertify the basic credential by earning sixty (60) recertification points obtained by attending seminars, workshops, CMA Today articles and college classes (must relate to the profession of medical assisting). Effective January 2007, a minimum of thirty (30) of the sixty (60) recertifying points must be obtained from AAMA approved continuing education units (CEUs). Due to the increasing frequency of emergencies in medical offices and clinics, CMAs (AAMA) must maintain current provider level CPR certification at all times. Effective January 2005, a CMA (AAMA) must submit proof of current provider level CPR certification in order to certify or recertify. Effective January 2007, to recertify by CEU's the CMA (AAMA) must accumulate ten (10) points in General, ten (10) points in Administrative and ten (10) points in Clinical. The remaining thirty (30) points may be accumulated in any of the three content categories. CEU points may not be carried over from one period of recertification to a subsequent recertification period.

Recertification can also be obtained by re-taking the certification examination, which is reconstructed annually. A certification credential that is kept current identifies competent medical assistants who have met and who continue to meet the professional standards established by the AAMA.

The CMA-A (AAMA) credential indicates candidates who passed the basic certification examination and the administrative specialty exam offered through 1983. The CMA-C (AAMA) credential indicates candidates who passed the basic certification examination and the clinical specialty exam offered through 1984. The CMA-P (AAMA) credential indicates candidates who passed the basic certification examination and the pediatric specialty exam offered through 1980. CMAs (AAMA) with a specialty credential may continue to use their specialty credential without recertifying them as long as their basic CMA (AAMA) credential is current. NOTE: Subspecialty credentialing is no longer available through AAMA.

As a rule, members attending AAMA approved programs do not pay a CEU registration fee while nonmembers may pay a fee set by the program planner. The AAMA Continuing Education Department maintains a transcript of all AAMA approved courses taken by each member. Transcripts are available free to members via the members' only section of the AAMA website, www.aama-ntl.org, or by calling AAMA at 1-800-ACT AAMA. Nonmembers are required to pay a fee for a transcript copy.

Current certification and recertification promotional materials and application forms can be obtained from the National office or the AAMA website. The Certification Chair should advertise to the membership how convenient it is to recertify the CMA (AAMA) credential by phone if all CEUs are AAMA approved. This requires a credit card and member must fax or mail CPR documentation separately.

The Certification Chair should submit articles to the NSMA Editorial Chair promoting certification and recertification. NSMA should recognize newly certified and recertified members by submitting names to the publication editor for print in the Med-A-Gram on a regular basis.

Supply the President and/or Certification Chair of local Chapters and Nebraska medical assisting program directors with information regarding the certification and recertification examination; where/how to apply, eligibility requirements, application deadlines, fees, application forms, etc. Keep Chapter Certification Chairs informed of changes in the certification/recertification program and the availability of new materials from AAMA.

Attend the NSMA annual conference (or arrange for a substitute) and provide attendees with information and answer questions regarding the certification and recertification program. Work with the conference chair to arrange for a table to display certification and recertification information and offer to make a brief presentation to attendees.

At regular intervals, AAMA will mail the names of newly certified medical assistants from Nebraska to the State

President and Membership Chair. The Membership Chair should follow-up on the nonmembers by sending them congratulations and information regarding joining AAMA. The Membership Chair will then forward a copy of the list to each Chapter and suggest that the Chapters also contact nonmembers in their region and offer an invitation to the next local meeting. The Certification Chair will be given a copy of the list and will mail a letter of congratulations from NSMA to each AAMA member on the list that is newly certified. Copies of the list will also be sent to the NSMA Marketing Chair who will send notices to employers and/or the schools new CMAs (AAMA) have graduated from.

Prior to the NSMA Annual Conference (February usually works best); the Certification Chair should request the list of recertified CMA's (AAMA) obtained through CEUs during the previous year from AAMA. Send a letter of congratulations from NSMA and refer names of nonmembers to the Membership Chair for follow up.

The Certification Chair should send a personal invitation to each newly certified and recertified CMA (AAMA) from the previous NSMA conference date to attend the annual conference where they will receive special recognition. Communicate with the Annual Conference Chair to arrange a time for a brief presentation at the awards ceremony to acknowledge those in attendance. A flower, token gift and/or a certificate may be part of the production.

Chair shall maintain a current listing of practicing CMA's (AAMA) in Nebraska (both member and nonmember) that includes the year of certification, recertification, demographics and place of employment. The AAMA office will be able to help keep this list updated.

Because CMA's (AAMA) are delegated advanced patient care duties and are assigned responsibilities requiring a high degree of trustworthiness, the AAMA Certifying Board developed disciplinary standards to protect patients. Chair should be familiar with the Disciplinary Standards and Procedures for CMAs (AAMA), which includes a list of grounds for denial of eligibility for the CMA (AAMA) credential and for the discipline of the CMA (AAMA).

The year-end report from the Certification Chair should include a list of names for the new CMAs (AAMA) and recertified CMAs (AAMA) for the term.

It is our conviction that your support and participation will make a lasting positive impact in the future of NSMA. If you are at all interested in learning more about the structure of our Society, duties of elected officers or the responsibilities of standing committee chairs, please contact me, the **Mentor Chair**, Andrea Stewart CMA (AAMA), PO Box 432 Sutherland, NE 69165, 308.386.6074, andycma@yahoo.com

Delegates Reports

Summary of the Delegates and Alternates reports from the 58th Annual AAMA Conference in St. Louis, Missouri October 17-20, 2014

The conference theme was "The Spirit of Discovery" and was held at the Hilton St. Louis at the Ballpark Hotel. There were 669 registrants. To help differentiate leaders on the national level, the Officers and BOT members wore different colored name tags.

The First-Timer and Student Reception

was attended by First-Time Delegate Jennifer Kocian, CMA (AAMA) and NSMA President Debra Potratz, CMA (AAMA). Linda Allensworth, CMA (AAMA) CPC attended as a AAMA CB Representative. The session was unorganized and chaotic. It would be beneficial to the first time attendees not only for the AAMA Officers and Board of Trustees to introduce themselves, but to elaborate on their role and what they do for the AAMA, and explain more about the history of the tri-level organization and the benefits of being an AAMA member. This event needs to be restructured.

Highlights from the Board of Trustees/Endowment Meeting

- Approved the renewal of the lease for the AAMA Executive Office Space in the Civic Opera Building.
- Approved a proposal from State Net for legislative monitoring to help the AAMA find and identify key legislation in the 50 states, the District of

Columbia, and the United States Congress, store and classify the information within State Net's secure online database, and provide flexible management and reporting tools for quick access and easy dissemination, including an automated e-mail alert system.

- Reached a consensus to continue the work of the Ad Hoc Committees on Health Information Technology with K.M., CMA (AAMA) PhD as Chair.
- Disbanded the Ad Hoc Committee to aid Develop Opportunities in the Health Care Environment, as the work they were charged with is being done by other committees.
- Disbanded the Ad Hoc Committee to Restructure the Annual Conference, however, the BOT will continue to monitor the results of the restructuring.
- Reached a consensus to provide attendee information collected at the PAHCOM and MGMA annual meetings to the Core Curriculum Task Force, so that the CCTF can continue the vital work of gathering data from employers regarding advanced practice.
- Approved revisions to the Representatives Bureau guidelines on States

requesting a grant from states needing assistance.

- Reviewed and discussed the recent article on medical assisting programs in the New York Times.
- Approved appointments to the Continuing Education Board task forces.
- Executive Director Don Balasa, JD, MBA gave an update on the presentation that he would be giving at the HOD as well as upcoming speaking engagements and his article in the CMA Today on Joint Commission.

Welcome and Awards Celebration:

The parade of state Presidents was held simultaneously with the Welcome party dessert bar. This combination created too much chaos and commotion as everyone was talking and eating and it was difficult to hear the MC as they introduced the state presidents. The state Presidents standing line awaiting their introduction found it very disrespectful. Hopefully this will be revamped next year.

A) Distinction Awards

Golden Apple – Mary Dey, CMA-AC (AAMA), BAS – Michigan

Leadership & Mentoring – Rusty Dowling, CMA (AAMA) – Michigan

Medical Assistant of the Year –
Kathy Puckett, CMA (AAMA) -
Oregon

The Excel Awards are categorized by the following divisions:
Section A = 200 members or fewer;
Section B = 201-500; Section C = 501-800; and
Section D = 801 members or more.

B) Publishing – EXCEL AWARD to

Section C – **NEBRASKA** -
MED-A-GRAM

Section D – Michigan - The
Michigan Medical Assistant
Journal

Achievement Awards – Texas
(C), Ohio (D), New York (D),
Washington (D), N. Carolina (D)

C) Website Development – EXCEL AWARD to

Section C – NEBRASKA –
www.nsmaonline.org

Section D – North Carolina
Achievement Awards – Arizona
(B), South Carolina (D), Ohio (D)
& Georgia (D)

D) Marketing, Promotion and Recruitment to

Section C – Texas
Section D – Oregon

E) Membership Retention – EXCEL AWARD to

Section A – Montana
Section B – Maine
Section D – Wisconsin
Achievement Award – North
Dakota (A) and Idaho (B)

F) Membership Recruitment – EXCEL AWARD to

Section A – New Mexico

Section B – Alabama
Section C – New York
Achievement Award – Idaho
(B), Texas (C), Oregon (D)

G) Student Membership Recruitment – EXCEL AWARD to

Section A – Alaska
Section B – Alabama
Section C – Oregon
Achievement Award – Hawaii
(A) and Washington (D).

H) CMA (AAMA) Certification Award to – Greatest percentage
increase of member CMAs
(AAMA)

Section A – Hawaii
Section B – Idaho
Section C – New Jersey
Section D – Oregon

Student Award:

F.A. Davis presented the
Student Award to Shalan
Beasley, Cleveland State
Community College, Cleveland,
Tennessee for her essay.

State Leaders meeting:

Director of Membership David
Knight, announced some of the
new website tools, the program
planner guide, ELC courses, ability
to print state roster/labels off
the website and recertifying
online. A four-member panel
took turns answering questions
on how they keep their chapters
active and how to be a leader.
One of their statements was you
have to know where you are
headed and have goals, without
a vision there is no mission.
Other areas of discussion was to
host a Member Forum at your

state conferences for attendees
to ask questions regarding all
aspects of the AAMA. Another
suggestion was to have a student
ambassador recruitment
program.

AAMA added tutorials to the
website to help members learn
how to navigate the website.
Another new item on the AAMA
website when logged into your
account is that 30 days prior to
recertifying, if you get a green
light, you can recertify at that
time. If you do not get a green
light, you will have to complete
the required steps in the area
below before you can continue.
You will get an automated email
confirmation once you have completed
everything. However, you
can still call the AAMA to recertify,
or if it is before your 30 days of
expiration, but confirmation will
take 30 days to complete. AAMA
will still send out reminder cards
to recertifying members that are
coming due.

The AAMA Program department
approval has a direct FAX
line at (312) 635-3363. Program
Planners can FAX their attendance
forms to (312) 635-3364.

House of Delegates Orientation:

The Delegates and Alternates
attended the HOD Delegate/
Alternate Orientation. The session
was conducted by the Speaker of
the House Paula Purdy, CMA
(AAMA) and Vice Speaker of the
House Lisa Lee, CMA (AAMA).
General guidelines were reviewed
including parliamentary procedures,
the voting process, and how to
present a motion. For check-in, all

delegates and alternates are required to present their AAMA Membership Card as well as their Name Badge for entrance to the HOD. The Election of officers, trustees, and the nominating committee will be conducted by electronic ballot again this year. Turning Technologies Company demonstrated how the devices operated.

House of Delegates: The House of Delegates was called to order by Paula Purdy, CMA (AAMA), Speaker of the House. Opening reflections, presentation of the Colors, the National Anthem and the Pledge of Allegiance followed. AAMA Officers, Past Presidents, Life Members, and the AAMA staff were introduced. The report of the Credentials Chair showed the voting body as 140 possible votes with 134 registered and 6 proxy votes. The total voting power was 140, 71 was majority, and 94 was two-thirds vote.

Following the morning session of the HOD, the officer and trustee nominees mingled amongst the delegates in the audience for individual question and answer session. The issue about the surprise implementation of the Assessment-Based Recognition in order entry (ABROE) was discussed. When Nebraska asked a Trustee running for re-election why this was done without membership knowledge, the reply was that they were concerned for employees that had been with an office for 20 years about to lose their job because they did not have a

credential as required by the CMS's meaningful use requirements. Nebraska's reply was why not have them go back school, utilizing one of the many CAAHEP and ABHEs accredited programs and sit for the CMA (AAMA) exam? Their response was that they did not feel these people would want to go back to school at their age nor could afford the programs. This did not sit well for many reasons with the Nebraska delegation. Unfortunately, there was not enough time allocated to visit with all of them.

At the Reference Committee, all officer and committee reports were open for discussion.

The House of Delegates reconvened and the voting power remained the same at 140. Both Nina Watson, CMA (AAMA), CPC and Donald Balasa, JD, MBA presented a very long synopsis of the birth of the Assessment Based Recognition in Order Entry in order to try to justify having adopted it without discussion during an annual conference or HOD.

This was the second year Delegates used electronic "clickers" to vote. This method worked very efficiently but unfortunately, the proceedings was a fiasco since the Parliamentary Advisor did not understand what to do with the election results.

Election results:

President – Charlene Couch, CMA (AAMA), Virginia
Vice President – Paula Purdy, CMA (AAMA), Oregon

Speaker of the House – Lisa Lee, CMA (AAMA), Utah

Vice Speaker of the House – Debby Houston, CMA (AAMA), CPC, Virginia

Trustee – 2 Year Term - Loxie Kistler, CMA (AAMA), EdD, RN

Trustee – 2 Year Term - Deborah Novak, CMA (AAMA)

Trustee – 2 Year Term - Michael Pfeil, LVN, CMA (AAMA)

Unfortunately, Susan Hawes, CMA (AAMA) was deemed not elected by the HOD leaders even though out of the five (5) times the Delegates voted for Trustees, she received the majority votes during the first two voting episodes. During the Presidents Luncheon, the BOT announced that they offered Susan Hawes, CMA (AAMA) a one-year term as Trustee due to the mass confusion at the HOD on Sunday. Nebraska Delegates question the Board of Trustees role in the HOD and overstepping their boundary when they offered Susan Hawes, CMA (AAMA) a 1-year term.

Completing the 2nd year of their two-year term as Trustees were Patricia Hightower, CMA (AAMA), Freda Miller, CMA (AAMA), PCS, and K.M., CMA (AAMA) PhD.

Nominating Committee – Monica Case, CMA (AAMA) – TN, Sherry Bogar, CMA (AAMA) – TX, Laura Mitchell, CMA (AAMA) – OK, and Jennifer Amaral, CMA (AAMA) – CT

Another issue that was discussed with a Trustee was that the Delegates should not be voting for the top three Trustees all

at once. Every Trustee running should have a chance of earning all possible votes in the HOD and not being elected by majority vote.

Bylaws adopted at the HOD:

Article VI – Membership, Section 2, Qualifications. A. ACTIVE – An active member shall be one of the following: 2. Anyone who was an active member on 12/31/87, who has never been a CMA (AAMA), and who has maintained continuous active membership. Continuous active membership shall be defined as having dues postmarked or submitted electronically to the AAMA Executive Office by December 31 (the controlling time is that of sending, not receiving).

Resolutions: There were no Resolutions presented this year.

The Publishers Showcase:

The Publishers Showcase included publishers of medical assisting textbooks. Attendees could also take advantage of complimentary desserts and drinks.

Other topics of interest at the Conference: Delegates and Alternate Delegates had the opportunity to attend various educational sessions throughout the conference.

President's Banquet: The Nebraska Delegation made a donation to President Couch's charity in honor of her being installed as the AAMA President. The Ivy Reade Relkin Surveyor Training Fund collected \$2,795.00, and the Maxine Williams Scholarship Program collected \$3,151.00.

Submitted by,
Debra Potratz, CMA (AAMA)
Nebraska President

(This report was condensed from all the delegate and alternate reports submitted)

The Nebraska Society of Medical Assistants Delegate and Alternate delegates

Debra Potratz, CMA (AAMA),
*Nicole Dvorak, CMA (AAMA),
Jennifer Kocian, CMA (AAMA),
*Terrie King, CMA (AAMA), Linda Allensworth, CMA (AAMA) CPC,
Lori Kounovsky, CMA (AAMA),
Carol Hipke-Muske, CMA

(AAMA), *Janet Ueding, CMA (AAMA)

***Denotes reports not received to be included in the condensed summary.**

Note: Alternate Delegate Jan Frederick, CMA (AAMA) serves as First Vice Chair on the AAMA Certifying Board (CB). The AAMA CB Chair was unable to attend conference so Ms. Frederick had to step up and assume her responsibilities at the AAMA Conference. Since Ms. Frederick could not fulfill her obligations of a NSMA Alternate Delegate, she returned all NSMA funds received.

The 59th AAMA Conference will be held in Portland, Oregon September 18-21, 2015 at the Double Tree by Hilton Portland www.doubletreeportland.com/ with the theme of "Building Bridges."

The 60th AAMA Conference will be held in Reston, Virginia September 16-19, 2016 at the Hyatt Regency Reston www.reston.hyatt.com/en/hotel/our-hotel.html.

Thank You:

- To the 2014-2015 State Medical Advisory Board:
- To the 2014-2015 elected and appointed of NSMA State Board and local chapters.
- To the 2014-2015 elected and appointed members of the AAMA.

Without the support from members like you, our organization would not continue to grow.

2014 National AAMA Convention



2014-2015 AAMA President Couch with the Nebraska Delegation



NSMA President Potratz accepts the Excel Award for the NSMA website and the Med-A-Gram Editor, Carol Muske accepts the Excel Award in publishing for the Med-A-Gram from the AAMA President Watson



Nebraska Delegates and Alternates F) Debra Potratz, Nicole Dvorak, Jen Kocian B) Carol Muske, Linda Allensworth Lori Kounovsky, Janet Ueding, Terri King, Michel McKinney



President Potratz honored as NSMA President at the Awards event



Excel Awards event – Jen Kocian, Nicole Dvorak, Terri King, Marcia Franklin, Deb Potratz, Lori Kounovsky, Dona Marotta, Jan Frederick, Linda Allensworth, Janet Ueding



2015 AAMA House of Delegates



The Nebraska "family" enjoy a meal together during the conference



St. Louis City Hall and Ulysses S. Grant statue

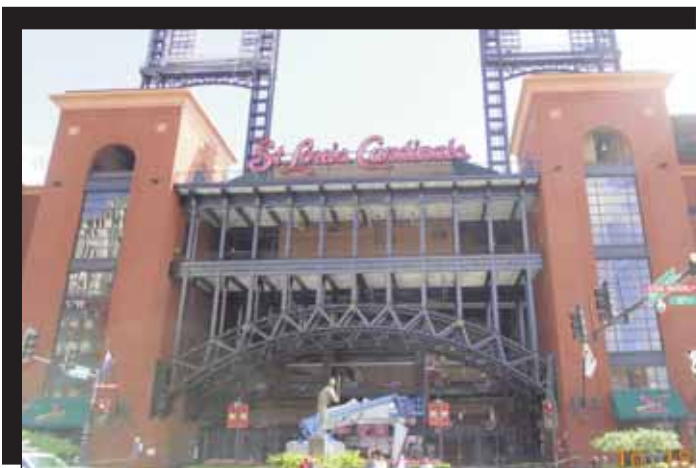

Busch Stadium home of the St. Louis Cardinals



Lori Kounovsky, Carol Muske, Deb Potratz and Jen Kocian
The St. Louis Archway in the background, the old Courthouse building between the Arch and us is a significant historical building. Dred Scott sued and won freedom from slavery for himself and his wife, a ruling that was ultimately overturned by the Supreme Court and was one of many leading factors to the Civil War.

NSMA Conference Grant Application

In an effort to reward active membership in the Nebraska Society of Medical Assistants, the Board of Directors has established the NSMA Conference Grant Program. One Grant will be offered annually, paying the full registration fee (non-transferable) to the next NSMA Annual Conference for the lucky winner.

One Grant will be offered annually and will pay the full registration fee to the Annual NSMA Conference.

APPLICANT CRITERIA

Requirements:

1. The current year's CMA (AAMA) dues paid and a member of the NSMA in good standing for a minimum of two consecutive years.
2. Must presently or in the past, held an active - officer position or committee chair at the Chapter level and served as an active - officer position or committee chair at the State level to be eligible.
3. Applicant must submit the completed the grant application form. A copy of their professional curriculum vitae, listing offices and committee positions held on both the local and state levels, and any other optional documents, i.e. letters of recommendation from peers, details of special projects, and specific contributions to the organizations that may assist the judges in evaluating the application by the established deadline. Only qualified candidates will be considered.

Winner will be notified as soon as possible after the announcement at the Spring BOD meeting.

Eligibility is limited to one grant award every five years for any one member.

An appointed panel of judges will select the winner, from the information provided in your application. Judges are the President, Vice President, Immediate Past President and the Awards chair.

Contact the current Awards Committee Chair with any questions or for more information.

Name: _____

Address: _____

AAMA Membership Number: _____ AAMA Member Since: _____

Phone: H) _____ W) _____

Membership Status: _____ Chapter Affiliation: _____

Application must be received by December 31, of each year. Send completed applications and supporting documentation to the NSMA Awards Chair. Please go to www.nsmaonline.org or check your current Spring Med-A-Gram for the current Awards Chair address.

Member-at-Large Contest

To all Nebraska Society Members-at-Large

In an effort to ensure that the Nebraska Society of Medical Assistants Member-at-Large are represented at the annual state House of Delegates, the State Society has developed a pilot incentive program. Complete the entry form below and return to the current NSMA Membership Chair by March 1, of each year. Upon receipt of your completed entry form, your name will be entered into a drawing for a free NSMA annual conference registration for that year. To qualify, you must be a member in good standing, meaning your AAMA dues have to have been received at the AAMA office by December 31st, of the previous year.

You must meet the guide-

lines for the member-at-large membership category:

- Live or work 60 (sixty) miles outside the nearest functioning Chapter.
- Must be available to attend the next NSMA Annual Conference in its entirety.

The duties of the winner of the free conference registration will include:

- Serve as a member-at-large Delegate at the Nebraska Society of Medical Assistants' House of Delegates (See the NSMA Bylaws section regarding Delegates to the House.)
- Serve as an active committee chair or member on the Board of Directors the following year.

- Maintain communication with the other members-at-large and see that they are kept informed of meeting highlights and other pertinent information throughout the year.

The NSMA is hopeful that this offering will inspire all members-at-large to be involved. Just complete the bottom portion of this announcement and see if you are the lucky winner. The drawing will be at the spring NSMA BOD meeting and the winner will be notified immediately. This award is non-transferable and only good for the year awarded.

To all Nebraska Society Members-at-Large: Member-At-Large Conference Delegate Entry Form

Name/Credentials _____

Address _____ City _____

Home Phone _____ Work Phone _____ Alternate Phone _____

Employer _____

E-mail Address: _____

AAMA Member ID #: _____

Applications are also available on-line.

Check you Spring Med-A-Gram or go online to www.nsmaonline.org
for the mailing address of the current Membership chair.

Return Completed Form (by March 1st of each year) to the NSMA Membership Chair.

EXCEL AWARD

*The American Association of Medical Assistants
is proud to present this award to the*

Nebraska State Society of Medical Assistants

Debra Potratz, CMA (AAMA), Web chair

for website development



AAMA 58th Annual Conference
October 2014

Nina L. Watson, CMA(AAMA)

President, American Association of Medical Assistants

EXCEL AWARD

*The American Association of Medical Assistants
is proud to present this award to the*

Nebraska State Society of Medical Assistants

Carol Hipke-Muske, CMA (AAMA), editor

for publishing

MED-A-GRAM



AAMA 58th Annual Conference
October 2014

Nina L. Watson, CMA(AAMA)

President, American Association of Medical Assistants

Nebraska Society of Medical Assistants
Carol Hipke-Muske, CMA (AAMA)
2014-15 Publication Editor
1414 N. Kansas Ave.
Hastings, NE 68901-3125
b_a_cma@hotmail.com
www.nsamonline.org

PRESORTED STD
U.S. POSTAGE
PAID
PERMIT #477
DUBUQUE, IA

www.nsmaonline.org

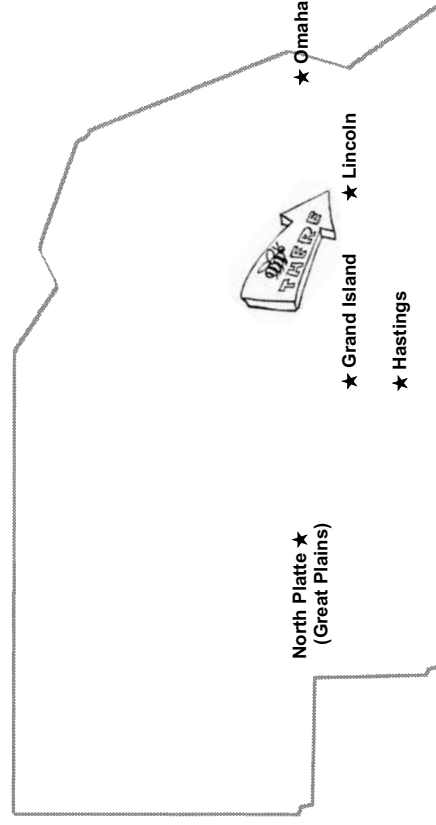

Attention: CMAs, RNs, LPNs and other ALLIED HEALTH PROFESSIONALS